



2001 Boeing 777-200ER VIP



Total time: 42,664 hours

Total cycles: 13,496

Range: 7,500 nautical miles

BOEING 777-212ER - SPECIFICATIONS



Seats 44 Pax

6 State Rooms

Ent. center with DVD/CD/iPad dock

Airshow with external cameras

9 Lavatories

2 Full Galleys

Cabin Height 9' 4"

Cabin Width 15' 6"

Range 7,500 nm

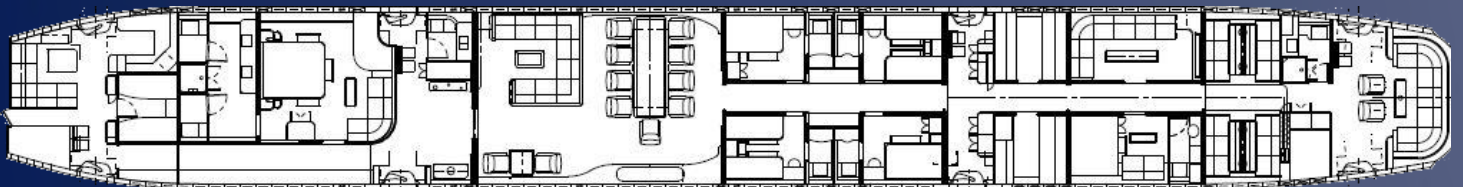

AIRCRAFT INTERIOR



Specifications and times are subject to verification. Aircraft offered is subject to prior sale, lease, and / or withdrawal from the market.

TECHNICAL DATA

AIRFRAME

Total Hours Since New: 42 664
Total Landings Since New: 13 496
Date of Manufacture: June 28th, 2001

ENGINES

Manufacturer: Rolls-Royce
Model: Trent 800 (RB211-Trent 892-17)

	Engine No.1	Engine No.2
Engine Serial Number:	51389	51409
Last Shop Visit:		
Total Time Since New:	39720 EH	57379 EH
Total Cycles since new:	9092 EC	10452 EC
LLP Limiter:	ANNULUS FILLER, LP COMPRESSOR	
	2024 EC	1114 EC

APU Type: HONEYWELL
APU SERIAL NUMBER: P-1233
Total Time: 34 016 APU-H / 20 145 APU-S

LANDING GEARS

	Part Number	Serial Number	Last OVH	CSLV	Next OHL
NLG	162W2000-2	BFG4282HMC	06/2023	43	06/2033
LH MLG	161W0000-45	MC0713P0343	06/2023	43	06/2033
RH MLG	161W0000-46	MC0720P0346	06/2023	43	06/2033

MAINTENANCE STATUS

Aircraft performed 3C Check on July 7th, 2025.
Next A check due on January 3rd, 2026.
Next C check due on April 2nd, 2028.

AIRCRAFT INTERIOR



AIRCRAFT INTERIOR

